

 **Visiting TFAM**

Taipei Fine Arts Museum

Address: No.181, Sec. 3, Zhongshan N. Rd., Zhongshan Dist., Taipei City 10461, Taiwan, R.O.C.

Telephone: +886 2 25957656 Fax: +886 2 25944104

Email: info@tfam.gov.tw

 **Museum Hours**

Monday	Tuesday	Wednesday	Thursday	Friday	Saturday	Sunday
Closed	9:30~17:30	9:30~17:30	9:30~17:30	9:30~17:30	9:30~ 20:30	9:30~17:30

 **Tickets**

Category of Tickets	Ticket prices (NT dollar)	For Visitors
Regular Ticket	30	General visitors above 18 years old
Discount Ticket	15	<ol style="list-style-type: none"> Students (including foreign students) above 18 years old with valid student ID Military and Police personnel with valid IDs Volunteers of educational or cultural institutions with valid ID
Group Ticket	30% Discount	Groups with more than 20 members
30th Anniversary Ticket	Theme III 180/set	<ol style="list-style-type: none"> Limited Edition,total sell :1688sets(1envelope+4 Regular tickets+4 Discount tickets,with coupons) Use Period:During the Museum's opening hours(Without Special Exhibitions) 30th anniversary ticket -Theme III

Admission Free	<ol style="list-style-type: none"> 1. General visitors under 18 years old 2. Physically or mentally challenged persons and one guardian or necessary companion. 3. Low-income persons with certification issued by Taipei City Government. 4. Citizens above 65 years old. 5. Tour guides leading groups, with certification issued by Bureau of Tourism, Ministry of Transportation and Communications. 6. Members of the International Council of Museums (ICOM), the American Association of Museums (AAM), or Chinese Association of Museums of the Republic of China with ID. 7. Volunteers with Honorary Voluntary Service Card or Taipei City Public Spirit Card (including voluntary workers, members of voluntary traffic police, voluntary police, voluntary firefighters and civil defense personnel, etc.) 8. Off-campus teaching or scholarly exchange programs of art-related departments of public or private schools, colleges or vocational schools of Taipei City, after having applied in advanced and received approval from Taipei Fine Arts Museum. 9. Groups of 10 or more persons organized by the districts of Taipei City, after having applied in advanced and received approval from Taipei Fine Arts Museum. 10. Government organizations or arts groups holding art-related activities, after having applied in advanced and received approval from Taipei Fine Arts Museum. 11. Taipei Fine Arts Museum may announce free admission during installation (or deinstallation), museum celebrations, art festivals, International Museum Day or other art-related special events. 12. Indigenous elders above 55 years old, registered in Taipei City (with Household Certificate or Senior Citizen Easy Card) 13. Students with valid student ID on Saturdays (Museum Learning Day) 14. After 17:00 on opening days.
----------------	--

Note :

1. Discount tickets or free admission require a valid ID.
2. Admission Tickets indicated in this table do not include tickets for special exhibitions or events held jointly by Taipei Fine Arts Museum and non-governmental organizations.
3. In order to maintain the quality and safety of your exhibition visit, please keep aside your selfie equipment before entering into the show.
4. **Free admission for galleries on the Basement Floor and Children’s Art Education Center.**
5. **Free admission from 17:00~20:30 on Saturday.**
6. **Free admission for students on Saturday (Learning Day of the Museum).**

Visiting Route

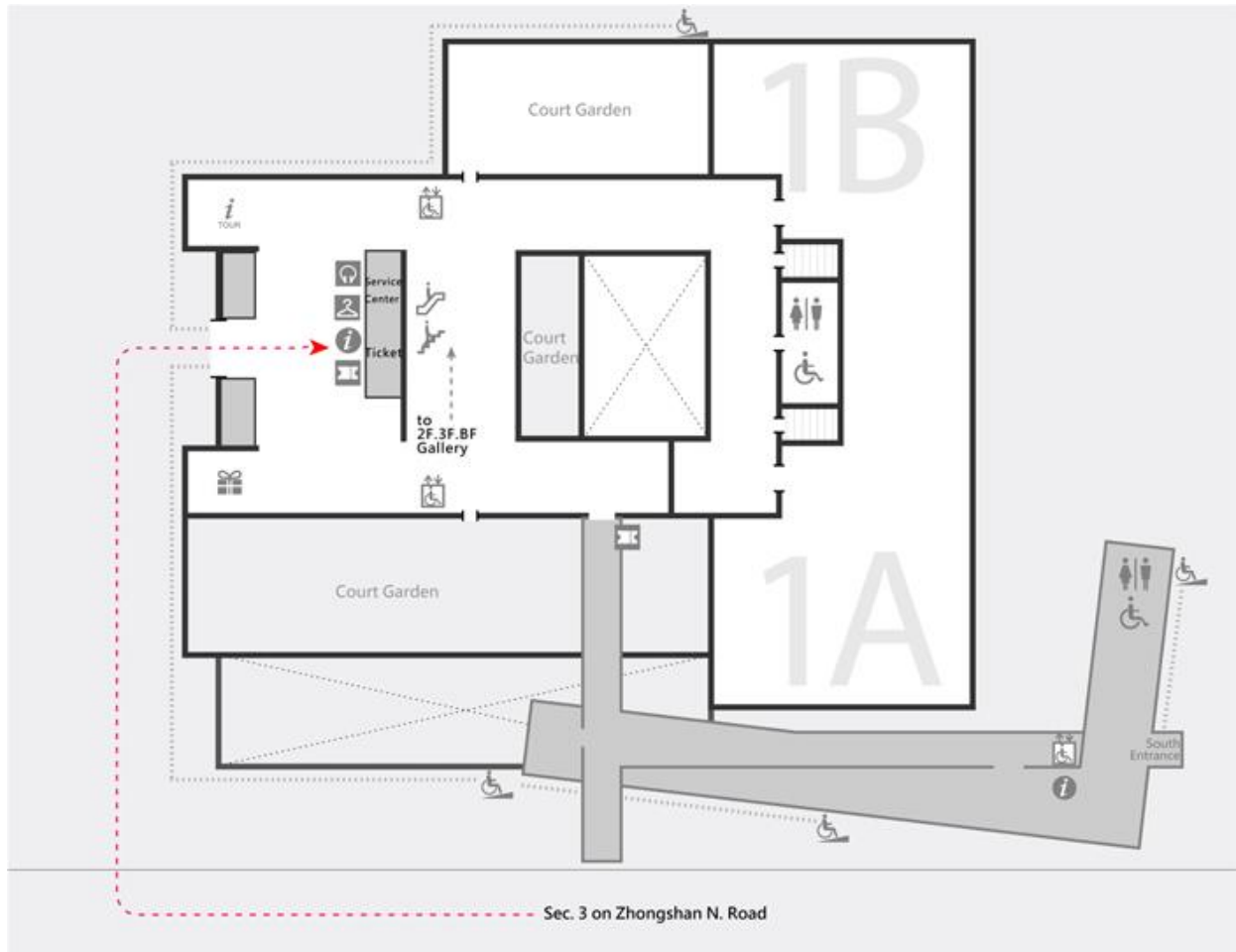

i GETTING HERE

+ **By MRT (Metro)**

Walk through Yuanshan Park Area from MRT Yuanshan Station, then turn left to Sec. 3 on Zhongshan N. Road. The walk takes about ten minutes.

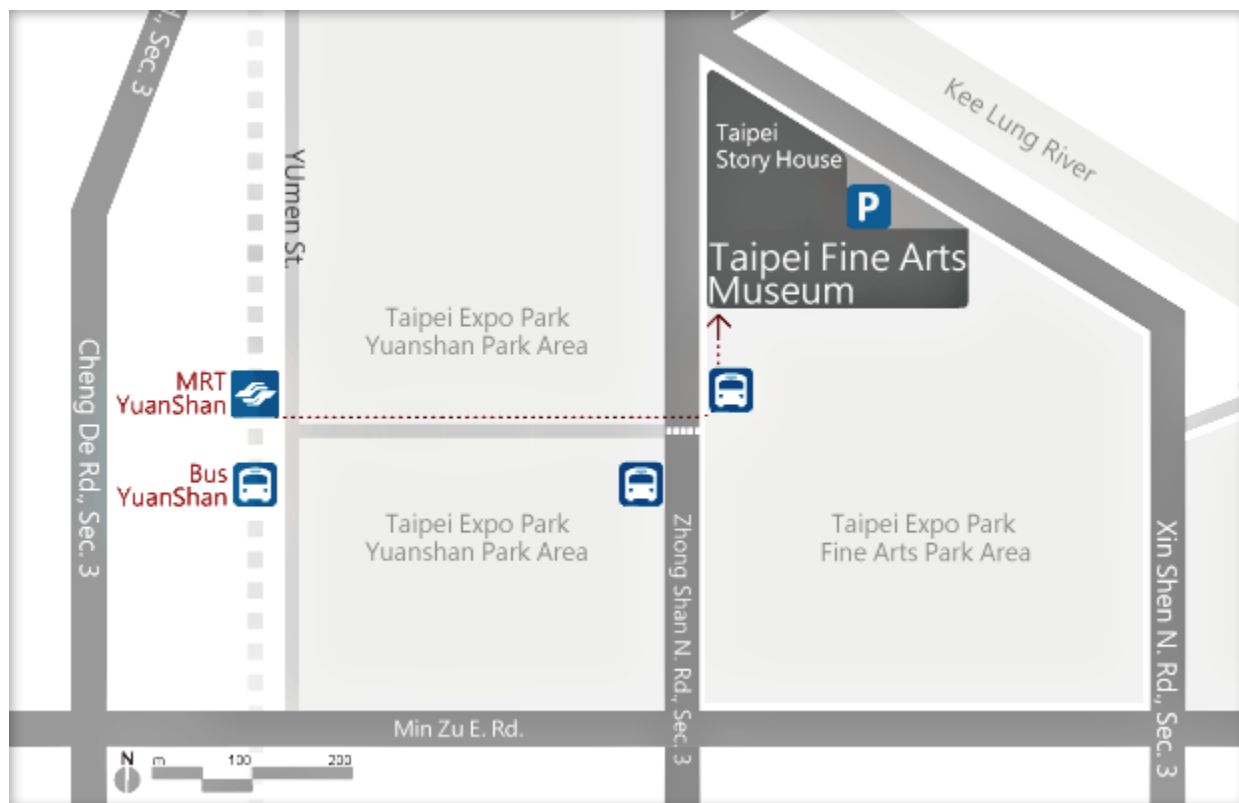

By Bus

The following buses stop at the “Taipei Fine Arts Museum”: routes 21, 42, 203, 208, 218, 220, 247, 260, 277, 287, 279, 310, 612, 677, 1717, 2022, 9006, Red2, the Zhongshan MainLine.

- * Bus stop location: in front of the museum(to the north);and at the intersection of Yuanshan Park Area and Sec.3 Zhongshan N. Road.(to the south)
- * 203, 277, 279, 612 sign only at the stop to the north
- * Red2, 21,and 220 are Low-Floor buses.

 **By Car**

Head east on Zhongshan Highway toward Exit Yuanshan Interchange and merge onto Songjiang Rd., then turn right onto Minzu E. Rd.. Go straight on and turn right onto Zhongshan N. Rd. Sec.3, and you will see TFAM on your right-hand side after about a minute.

Free Parking

Free parking for museum's visitors,

Opening Hours: Tuesday to Sunday 9:20 am ~ 19:30 pm, Saturday opens until 22:00 pm. Closed on Monday.

