

 **Visiting TFAM**

Taipei Fine Arts Museum

Address: No.181, Sec. 3, Zhongshan N. Rd., Zhongshan Dist., Taipei City 10461, Taiwan, R.O.C.

Telephone: +886 2 25957656 Fax: +886 2 25944104

Email: info@tfam.gov.tw

 **Museum Hours**

Monday	Tuesday	Wednesday	Thursday	Friday	Saturday	Sunday
Closed	9:30~17:30	9:30~17:30	9:30~17:30	9:30~17:30	9:30~20:30	9:30~17:30

 **Tickets**

Category of Tickets	Ticket prices ( NT dollar )	For Visitors
Regular Ticket	30	General visitors above 18 years old
Discount Ticket	15	<ol style="list-style-type: none"> <li>Students (including foreign students ) above 18 years old with valid student ID</li> <li>Military and Police personnel with valid ID</li> <li>Volunteers of educational or cultural institution with valid ID</li> </ol>
Group Ticket	30% Discount	Groups with more than 20 members
30th Anniversary Ticket	Theme I 180/set	<ol style="list-style-type: none"> <li>Limited Edition,total sell :2013 sets(1envelope+6 Regular tickets)</li> <li>Use Period:During the Museum's opening hours(Without Special Exhibitions)</li> <li>30th anniversary ticket -Theme I</li> </ol>
	Theme III 180/set	<ol style="list-style-type: none"> <li>Limited Edition,total sell :1688sets(1envelope+4 Regular tickets+4 Discount tickets,with coupons)</li> <li>Use Period:During the Museum's opening hours(Without Special Exhibitions)</li> <li>30th anniversary ticket -Theme III</li> </ol>

Admission Free	<ol style="list-style-type: none"> <li>1. General visitors under 18 years old.</li> <li>2. Citizens above 65 years old.</li> <li>3. Aborigines household registered in Taipei from 55 to 64 years old.</li> <li>4. Physically or mentally handicapped persons and their one guardian or necessary companion.</li> <li>5. Low income persons with certification issued by Taipei City Government.</li> <li>6. Members with ID of the International Council of Museums (ICOM), the American Association of Museums(AAM), or Chinese Association of Museums of the Republic of China.</li> <li>7. Volunteers with Honorable Cards for Voluntary Service.</li> <li>8. Group visitors' tour guides with certification issued by Tourism Bureau of Tourism, Ministry of Transportation and Communications.</li> <li>9. Off campus teaching and scholarly exchange of public and private schools of Taipei City and art-related departments of colleges and training schools with their application approved by our Museum.</li> <li>10. For art-related activities sponsored by government organizations, with application applying in advance to and approved by our Museum.</li> <li>11. Group of 10 or more persons organized by the districts of Taipei City, with application applying in advance to and approved by our Museum.</li> <li>12. Our Museum may announce free admission during special events of art-related activities;such as exhibition arrangements(or removals), art festival celebrations, the International Museum Day, etc.</li> </ol>
----------------	--

Note :

1. Discount ticket or free admission requires a valid ID.
2. Admission Tickets referred in this table does not include the tickets sold for special exhibition activities held jointly by our Museum and non-government organizations.
3. In order to maintain the quality and safety of your exhibition visit, please keep aside your selfie equipment before entering into the show.
4. **Free admission for galleries on the Basement Floor and Children's Art Education Center.**
5. **Free admission from 17:00~20:30 on Saturday.**
6. **Free admission for students on Saturday (Learning Day of the Museum).**

## Visiting Route

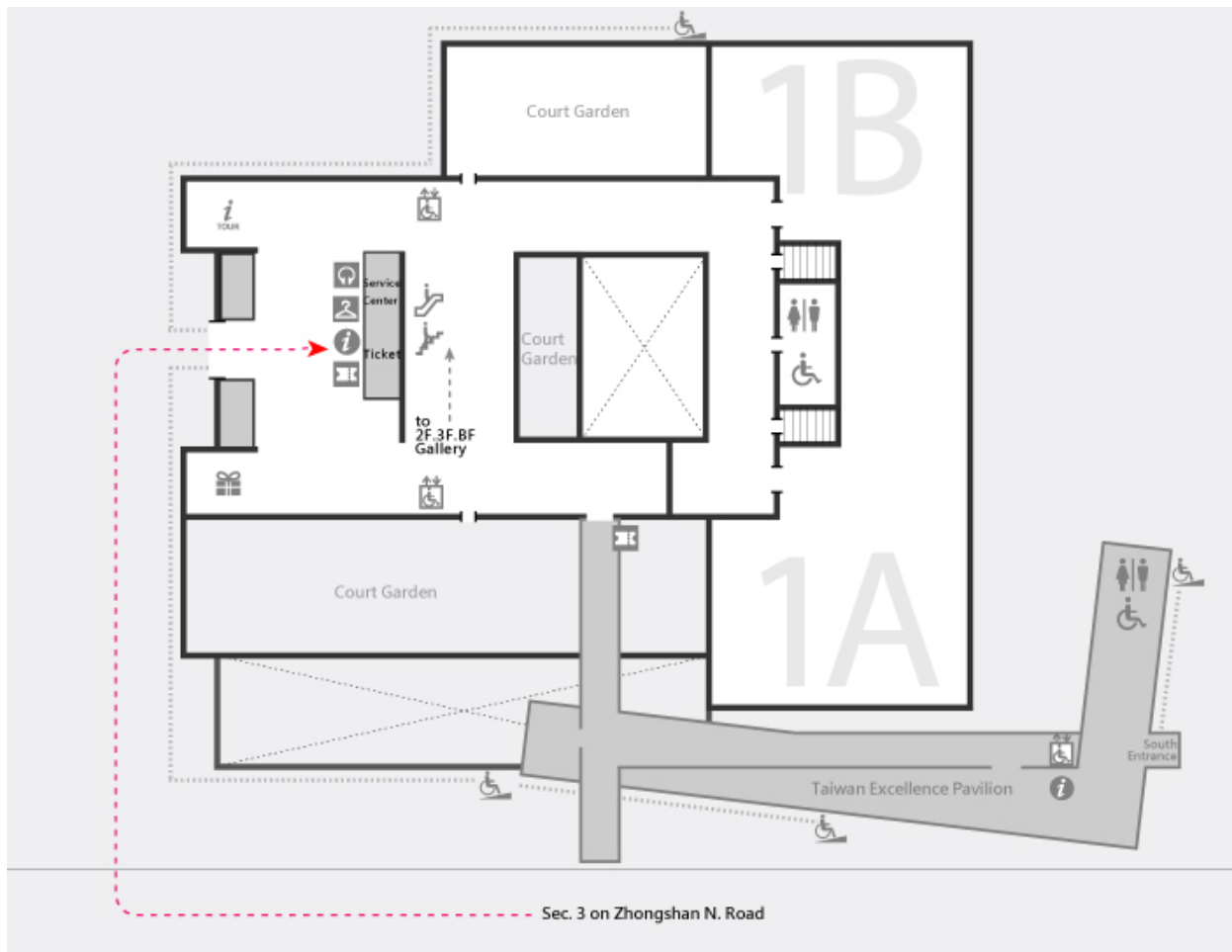

**i** GETTING HERE

**+** **By MRT (Metro)**

Walk through Yuanshan Park Area from MRT Yuanshan Station, then turn left to Sec. 3 on Zhongshan N. Road. The walk takes about ten minutes.



**By Bus**

The following buses stop at the “Taipei Fine Arts Museum”: routes 21, 42, 203, 208, 218, 220, 247, 260, 277, 287, 279, 310, 612, 677, 1717, 2022, 9006, Red2, the Zhongshan MainLine.

- \* Bus stop location: in front of the museum(to the north);and at the intersection of Yuanshan Park Area and Sec.3 Zhongshan N. Road.(to the south)
- \* 203, 277, 279, 612 sign only at the stop to the north
- \* Red2, 21,and 220 are Low-Floor buses.

 **By Car**

Head east on Zhongshan Highway toward Exit Yuanshan Interchange and merge onto Songjiang Rd., then turn right onto Minzu E. Rd.. Go straight on and turn right onto Zhongshan N. Rd. Sec.3, and you will see TFAM on your right-hand side after about a minute.

**Free Parking**

Free parking for museum's visitors,

Opening Hours: Tuesday to Sunday 9:20 am ~ 19:00 pm, Saturday opens until 22:00 pm. Closed on Monday.

- \* On Tuesday to Sunday after 17:15pm opens only for vehicles out of the parking lot.
- \* On Saturday after 20:15pm opens only for vehicles out of the parking lot.

